

**2**

46283

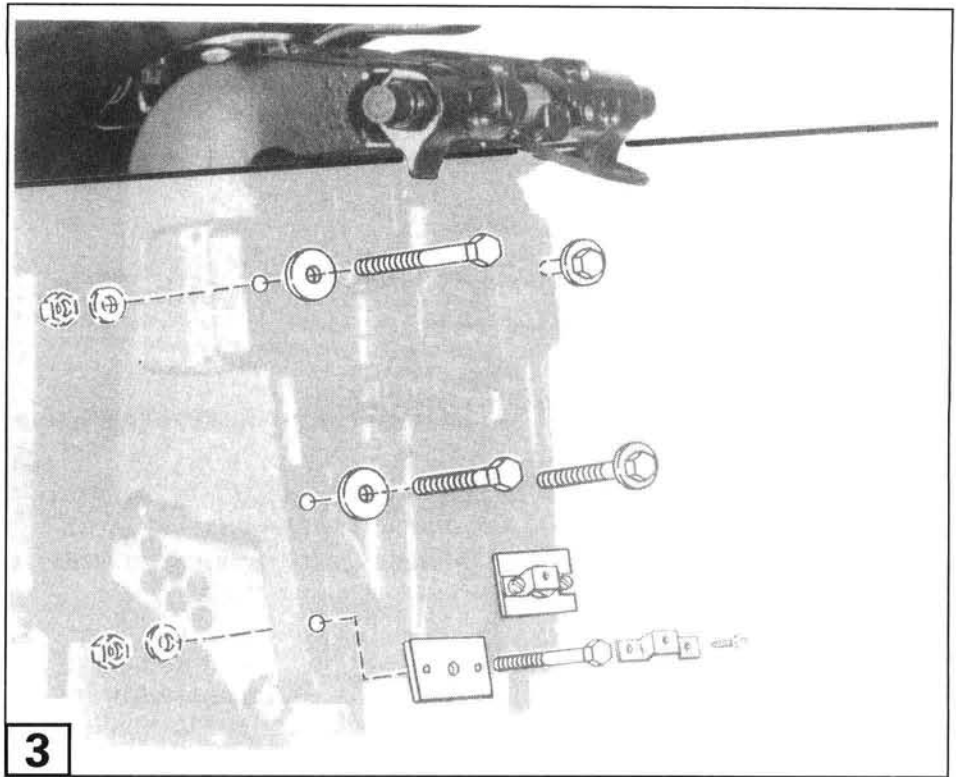

**3**

DR5536

## Lifting Information

**2** ⚠️ Install **OMC Lifting Tool**, P/N 342672, on crankshaft. **Tighten mounting screw securely using an Allen 1/4 in. hexagonal wrench.**

**4** **Note** Do not allow the hoist lifting hook or chain to make contact with any part of the engine during lifting.

## Secure Outboard to Transom

⚠️ Grease and install steering cable in tilt pivot tube. **Tighten anchor nut to steering manufacturer's recommended torque.**

**3** Use the mounting hardware that attached outboard to shipping carton to secure outboard to transom. For procedures, refer to Installation Guidelines, P/N 507226. Tighten mounting bolt locknuts in the following sequence:

- 10 ft. lbs.
- 25 ft. lbs.
- 40 ft. lbs.

Remove **OMC Lifting Tool** from crankshaft.

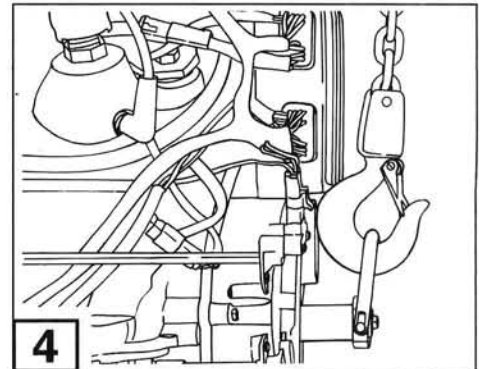

**4**

DRC6864